

2ND FLOOR PLAN

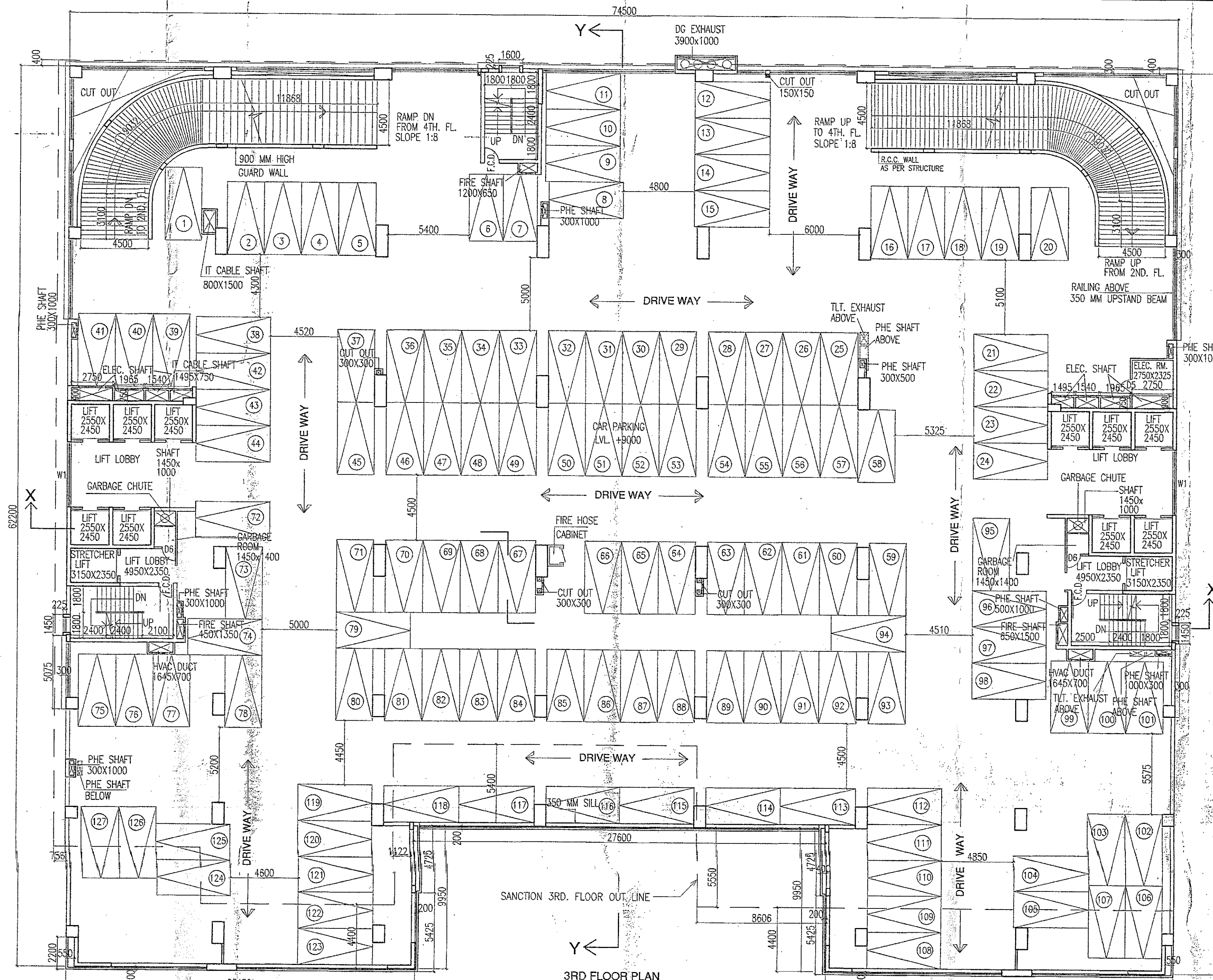

3RD FLOOR PLAN

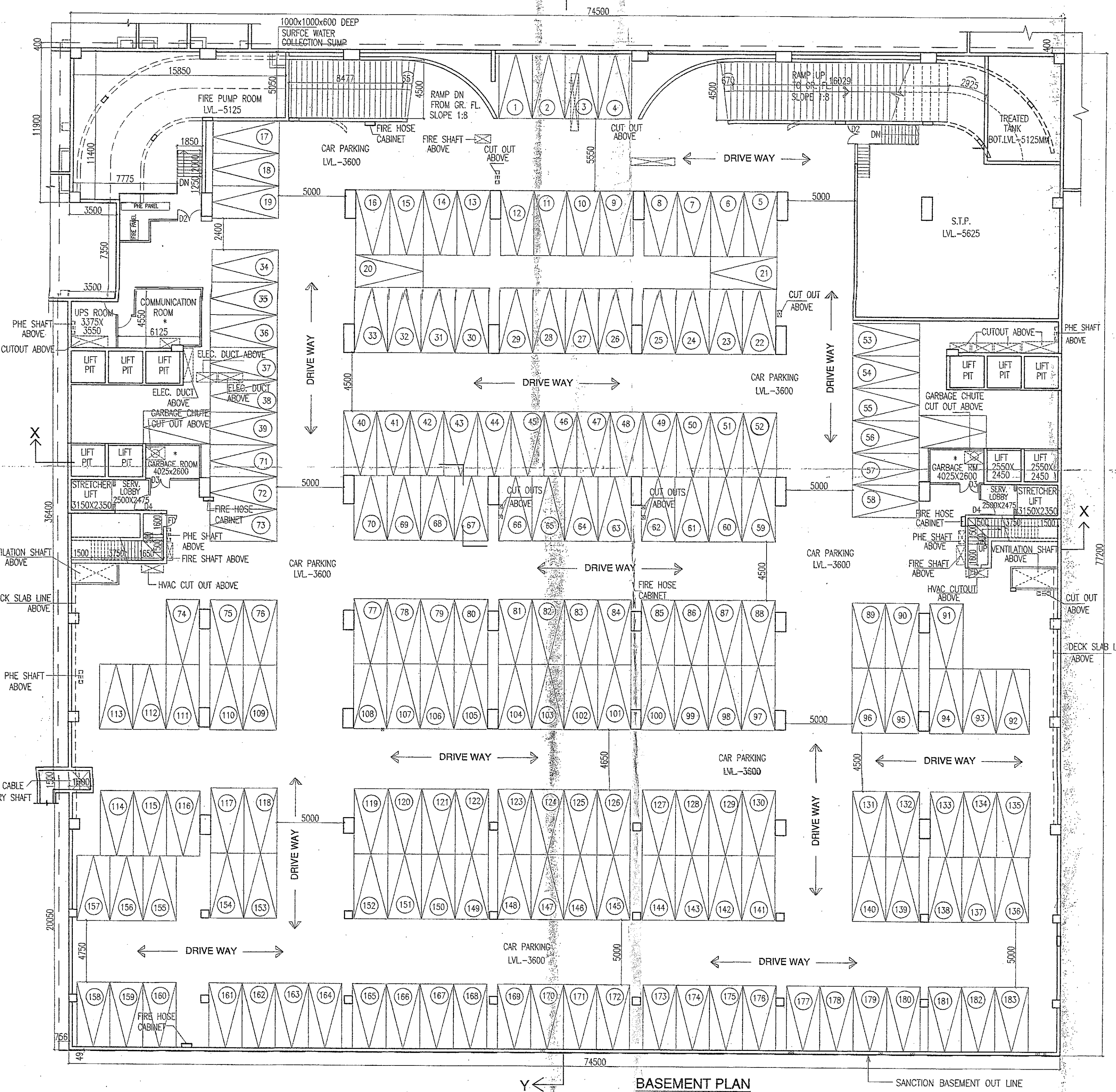

BASEMENT PLAN

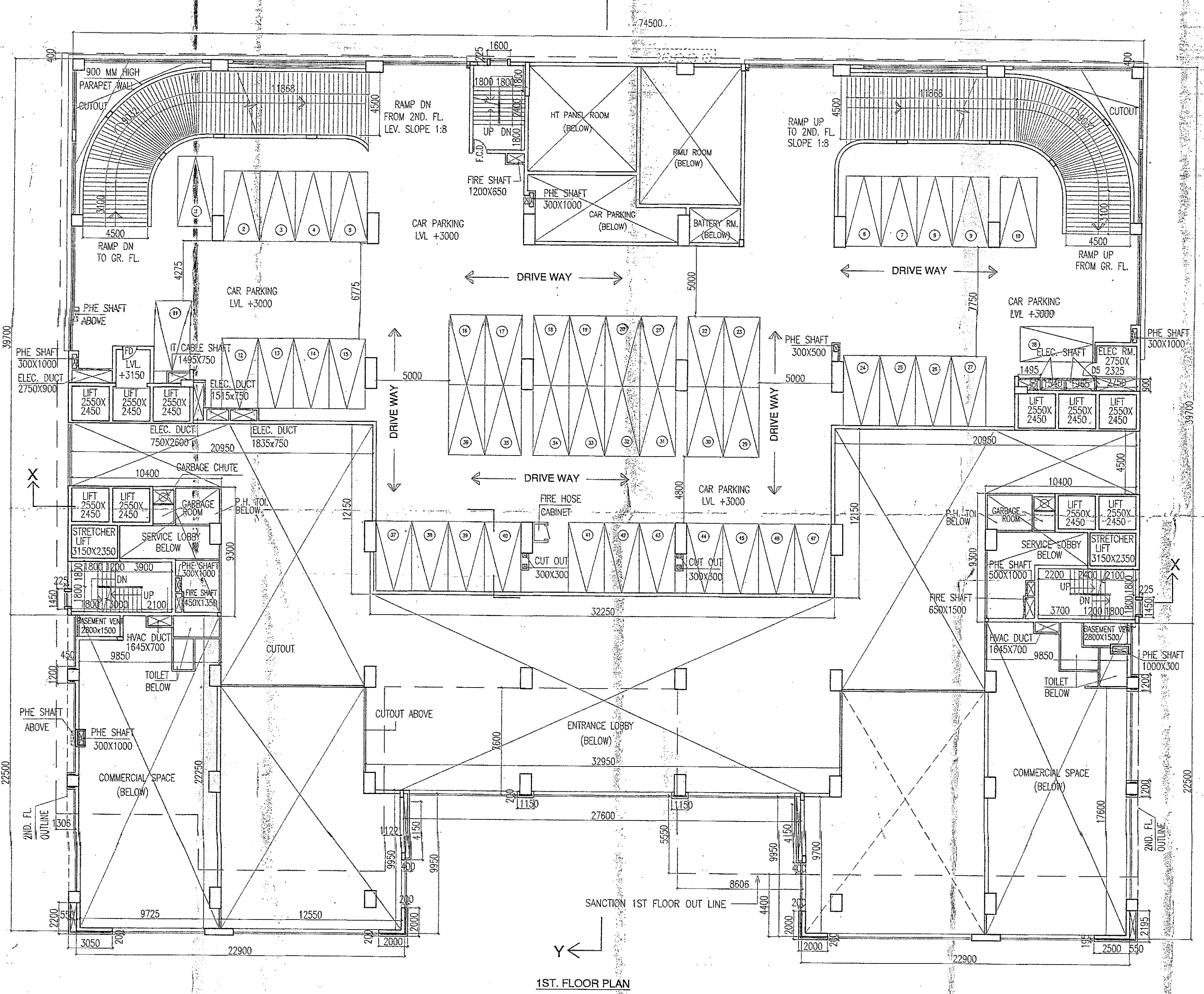

1ST FLOOR PLAN

DOOR & WINDOW SCHEDULE:

TYPE	SIZE	SKILL	LINTEL
D1	2000X2150	-	2150
D2	1800X2150	-	2150
D3	1500X2150	-	2150
D4	1200X2150	-	2150
D5	1000X2150	-	2150
D6	900X2150	-	2150
D7	750X2150	-	2150
FD	1000X2150	-	2150
W1	4500X1550	900	2450
W2	1200X1550	900	2450
SW	1000X1550	900	2450
R/S1	3000X1550	-	2450
R/S2	1000X1550	-	2450
R/S3	1500X1550	-	2450
C.G.	AS PER ELEVATION		CURTAIN GLASS

NOTE:
* - ARTIFICIAL LIGHTING & MECHANICAL VENTILATION
N.B. - ALL LIFTS, LOBBIES & STAIRCASES SHALL BE PRESSURISED AS PER GUIDE LINE OF N.B.C.P.V

CERTIFICATE OF OWNER
THE OWNER HAS CERTIFIED ON THE BUILDING PLAN WITH FULL RESPONSIBILITY THAT I HAVE GONE THROUGH THE WEST BENGAL MUNICIPAL BUILDING RULES AND ALSO UNDER TAKE TO ABIDE BY THOSE RULES DURING AND AFTER CONSTRUCTION OF THE BUILDING.

SIGNATURE OF OWNER

CERTIFICATE OF STRUCTURAL STABILITY
WE HEREBY CERTIFY THAT THE FOUNDATION AND SUPERSTRUCTURE OF THE BUILDING PROPOSED FOR CONSTRUCTION OF SOFTWARE PARK AT PLOT NO. - 5, BLOCK-BN, SECTOR - V, SALT LAKE ELECTRONIC COMPLEX, BIDHANNAGAR, KOLKATA - 91 HAVE BEEN SO DESIGNED BY US WILL MAKE SUCH FOUNDATION AND SUPERSTRUCTURE SAFE IN ALL RESPECTS INCLUDING THE CONSIDERATION OF BEARING CAPACITY & SETTLEMENT OF SOIL ETC.

SIGNATURE OF STRUCTURAL ENGG.

SIGNATURE OF GEO-TECHNICAL ENGG.

CERTIFICATE OF ARCHITECT
CERTIFIED THAT THE PLAN HAS BEEN DESIGNED & DRAWN UP STRICTLY ACCORDING TO THE BUILDING RULES FOR INDIA.

SIGNATURE OF ARCHITECT.

TITLE:
BASEMENT PLAN, 1ST. FLOOR PLAN
2ND. FLOOR PLAN, 3RD. FLOOR PLAN

PROJECT:
REVISED / COMPLETION PLAN OF S-G-KIX STORED BUILDING PLOT NO. - 5, BLOCK-BN, SECTOR - V, NABADIGANTA INDUSTRIAL TOWNSHIP, KOLKATA - 91. PREVIOUSLY SANCTIONED VIDEO NO. V / BM / 22 R DATED - 29.12.2007

CERTIFICATE OF STRUCTURAL REVIEWER

I HEREBY CERTIFY THAT THE BUILDING SITE PROPOSED FOR CONSTRUCTION AT PLOT NO. - 5, BLOCK-BN, SECTOR - V, KOLKATA - 91 UNDER JURISDICTION OF NDIA HAS BEEN VISITED BY ME AND ALL THE DESIGNING DRAWING C1 TO C5, SOIL TEST REPORT AND LOAD TEST RESULTS FOR FOUNDATION AND SUPER STRUCTURE HAVE BEEN DILIGENTLY REVIEWED CONFIRMING TO STIPULATIONS OF ALL LATEST RELEVANT I.S. CODE OF PRACTICE AND NATIONAL BUILDING CODE AND IT IS FOUND THAT EVERYTHING IS COMPLETELY IN ORDER & THE PROPOSED FOUNDATION AND SUPERSTRUCTURE ARE SAFE IN ALL RESPECT

SIGNATURE OF STRUCTURAL REVIEWER

SCALE	ARCHITECTS
1 : 200	AGRAWAL & AGRAWAL BARODA KOLKATA
DATE	DRG. NO. DEALT CHECKED
29.11.17	C2 KAUSHIK / PAULMI